

# Cruise Ships: Planning & Mitigation









# Juneau Alaska Cruise Passengers 1970 to 2019

57X

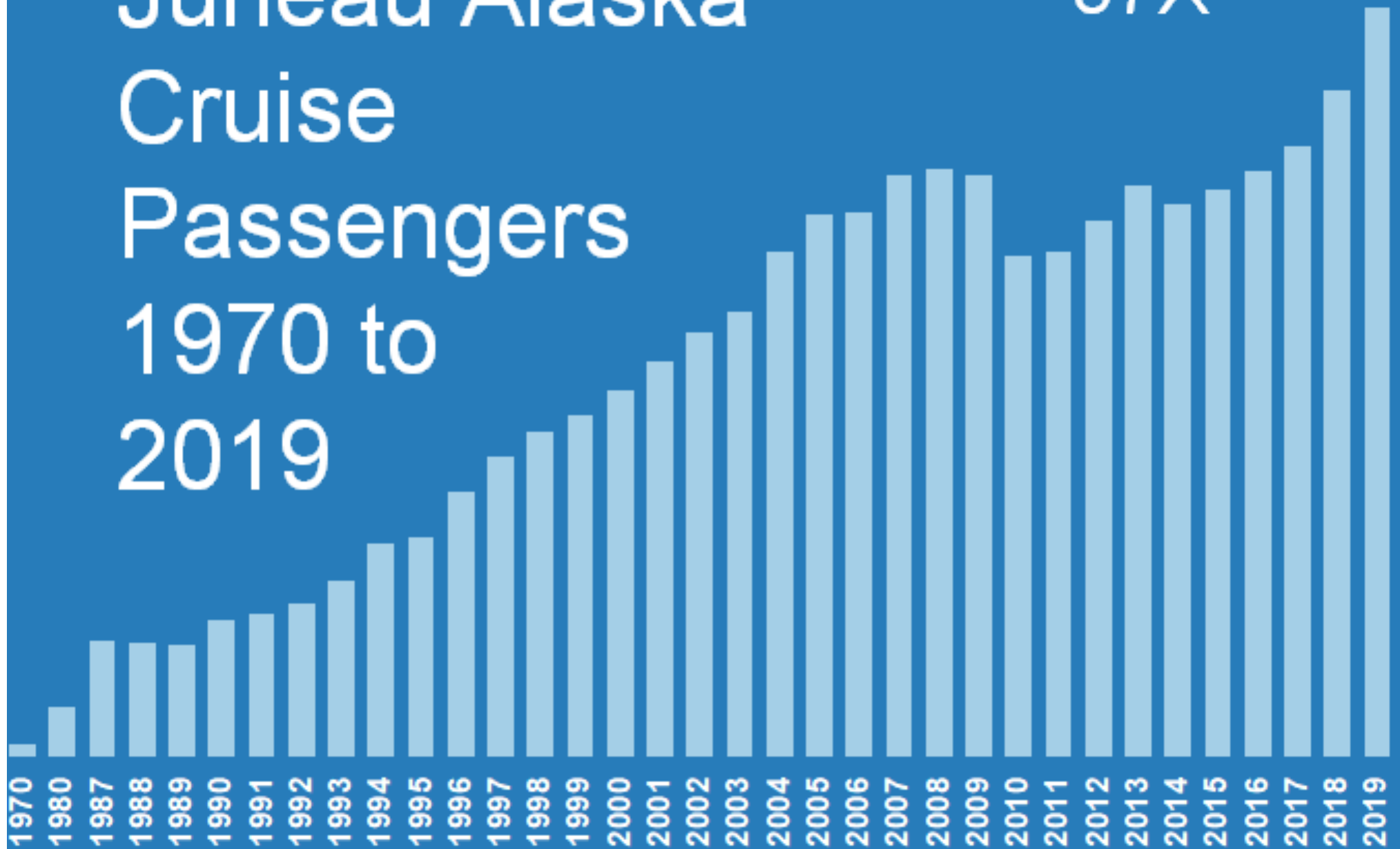

# Juneau Cruise Passengers

50% increase 2010-2019

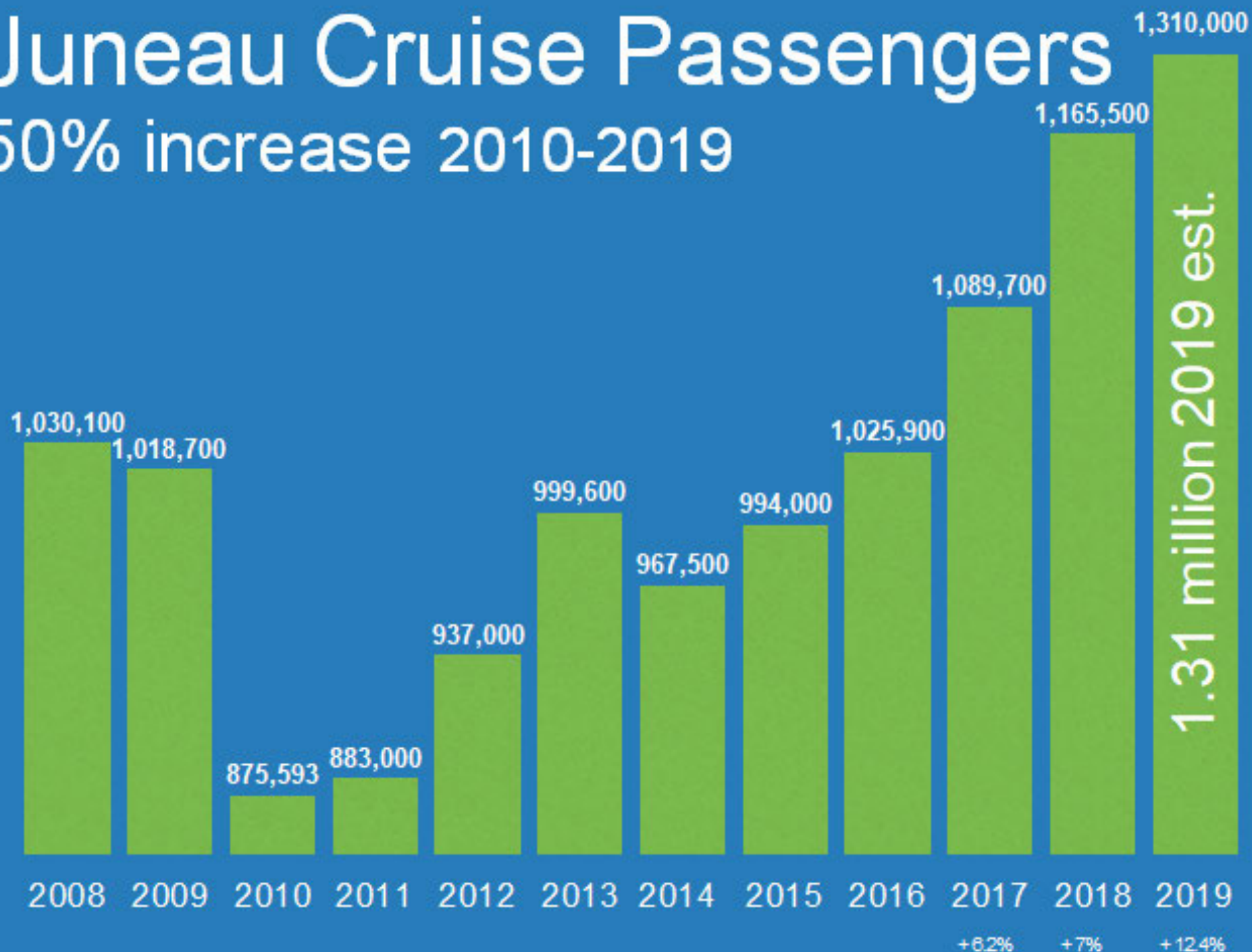



2009 Oasis of the Seas 220 000 2712 Cabins GT 360 × 47 × 9,1



2006 Freedom of the Seas 158 000 1816 Cabins GT 339 × 38,60 × 8,50 m



1999 Voyager of the Seas 137 300 GT 1557 Cabins 311,12 × 38,60 × 8,60 m



1996 Grandeur of the Seas 74 000 GT 975 Cabins 279,8 × 32,20 × 7,60 m



1990 Fantasy 70 400 GT 1028 Cabins 260,8 × 31,50 × 7,80 m



1982 Song of America 37 600 GT 707 Cabins 214,51 × 28,41 × 6,80 m



1970 Song of Norway 18 400 GT 377 Cabins 168,32 × 23,96 × 6,70 m









# Cruise Ship Dock Improvement



PROPOSED DOCK PROJECT



<b>P N D</b> ENGINEERS, INC.		6960 Glacier Highway, Suite 100 Juneau, Alaska 99801 Phone: 907.586.2000 Fax: 907.586.3550 www.pnd-inc.com		<b>CITY &amp; BOROUGH OF JUNEAU, ALASKA DOWNTOWN CRUISE SHIP DOCK RECONFIGURATION</b>
DESIGN: PND	CHECKED: PND	SCALE: SCALE IN FEET	DATE: 12/05/11	SHEET TITLE: SITE PLAN WITH BATHYMETRY
DRAWN: PJD	APPROVED: CRS	0 100 200 FT	PND PROJECT NO.: 102050.02 (DWG. FILE)	1 1 OF 1



# Cruise Ship Terminal Staging Area

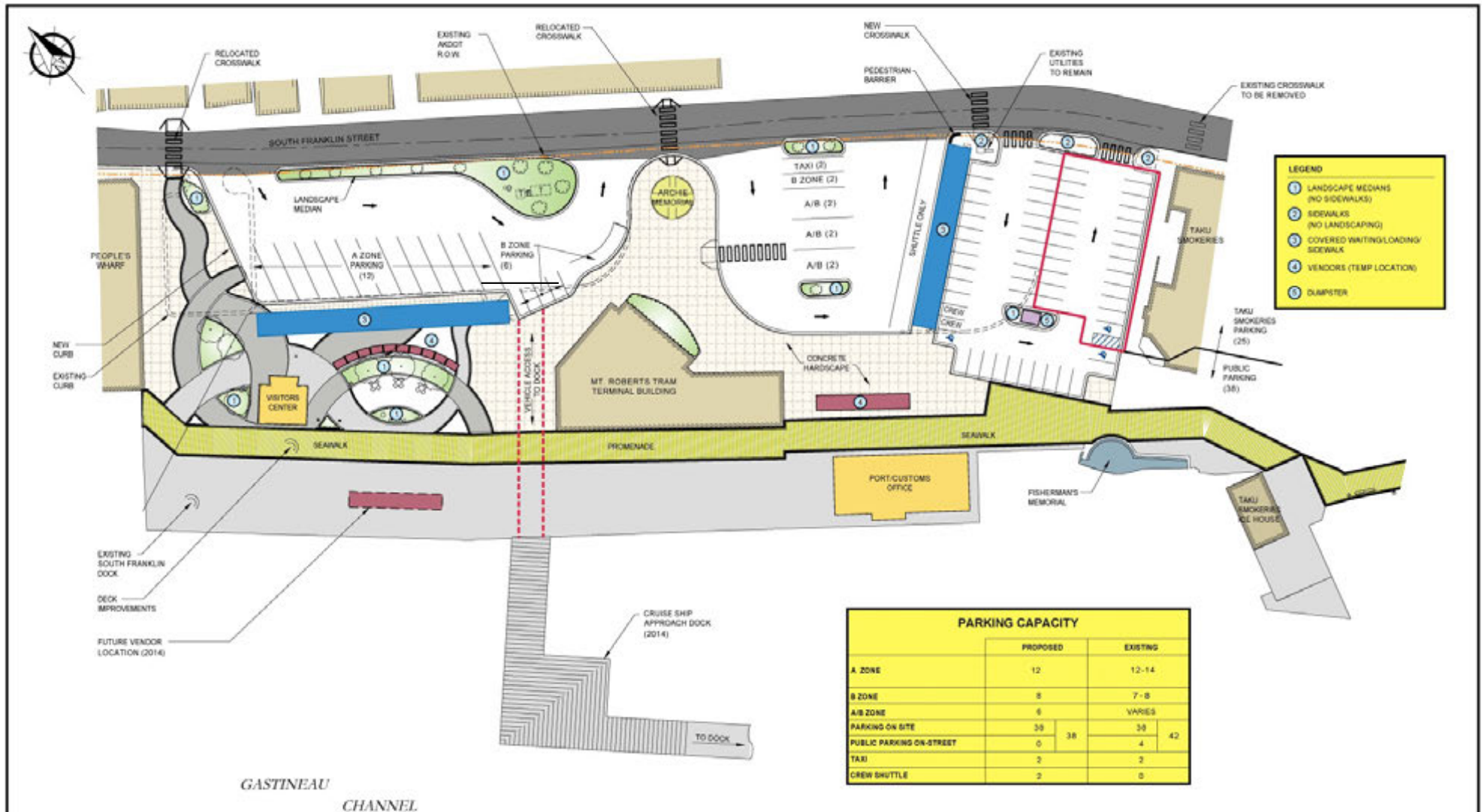









In 1997, in response to growing concerns about the impact of tourism on the community, local tourism operators took the initiative to develop the Voluntary Compliance Program. Over time, Voluntary Compliance evolved into **TOURISM BEST MANAGEMENT PRACTICES - TBMP**





TBMP was formed to address impacts to Juneau from its growing tourism industry:

- Congestion
- Flightseeing noise
- Ship emissions
- Commercial use of trails
- Carrying capacity – infrastructure and technology
- Marine tours and fishing charters; wake management



TBMP has created operator agreements addressing:

- Transportation and Vehicles
- Flight seeing (Helicopter & Fixed Wing)
- Walking, Hiking, & Biking tours
- Cruise Ship operations
- Marine tours, sightseeing, and sport fishing operators





## Elements Necessary for Success

### **Buy-in** from

- Tour operators
- Community
- Government

**Continuous communication, accountability, and review by all parties**